

Metal Deck Roof

Sample Specification

1. The insulation material shall be Anticon R___ Value (Specify type: R1.5, R2.0 or R2.5), as manufactured by CSR Bradford Insulation.
2. The insulation material shall be dry when installed and shall be kept dry.

3a For timber purlins up to 900mm centres:

"The insulation material shall be rolled out over the purlins allowing an even sag between them to provide sufficient space for the thickness of the insulation. Ensure that adjacent edges are tightly butted together."

Where maximum resistance to the penetration of water vapour is required - add:

"The 150mm wide foil overlap shall be sealed to the underside of the foil on the adjacent insulation by means of an approved contact adhesive or vapour impermeable pressure sensitive tape, applied in accordance with the manufacturer's recommendations. "

3b. For steel purlins, and for timber purlins above 900mm centres:

"Install wire mesh, Roofsafe, Roofguard, or approved equal across the purlins, the wire shall be dished so that following values correspond;

R1.5 minimum 55mm
R2.0 minimum 75mm
R2.5 minimum 95mm

sufficient to accommodate the insulation allowing it to perform to the specified value of the insulation. The edge wires of adjacent runs shall be twitched together at approximately 450mm centres."

4. The insulation material shall be rolled out over the wire mesh, ensuring that adjacent edges are tightly butted together.

Where maximum resistance to penetration of water vapour is required - add:

"The 150mm wide foil overlap shall be sealed to the underside of the foil on the adjacent insulation by means of an approved contact adhesive or vapour impermeable pressure sensitive tape (such as PPC 4150 FSK) applied in accordance with the manufacturer's recommendations."

Guide to Correct R Values by Location for Commercial Roofing

Following are major city guides, for other locations refer to the design guide.

<u>Location</u>	<u>Roof</u>	<u>Wall</u>
Adelaide	R2.0	R1.5
Brisbane	R1.5	R1.5
Canberra	R2.5	R2.0
Darwin	R2.5	R2.0
Hobart	R2.5	R2.0
Melbourne	R2.0	R1.5
Perth	R2.0	R1.5
Sydney (City)	R1.5	R1.5

Insulation - Roof Profile Matching

Most profiles have been installed with all R Values of Anticon, without distortion of the roof line. Refer to the table on the following page for a guide to fixing screws or refer to the Metal Deck manufacturer for further information.

If clip down type roofs are used, (such as BHP Klip-Lok), with R2.5 Anticon™, the use of a spacer (such as Deckmate™) is recommended, to allow for recovery of the insulation and ensure roof profile is even.

For surfaces where premium resistance to mechanical damage is required specify Anticon™ R ___ Value (Specify type: R1.5, R2.0 or R2.5), incorporating heavyweight Thermofoil™.

**Metal Roof Deck
Sample Specification**



Flat Metal Deck Roof With Ceiling Lining

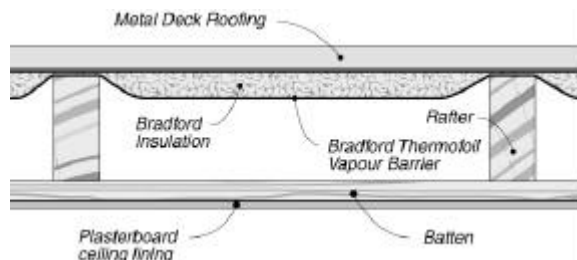

Flat Metal Deck Roof With No Ceiling Lining

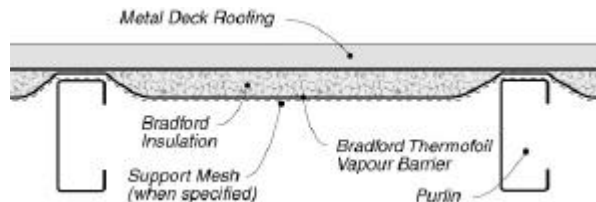

Bradford Anticon™ Roof Screw Lengths Required

Table 13. Bradford Anticon™ Roof Screw Lengths Required for Fixing Metal Deck Roofing

	R Value	Purlin T = Timber S = Steel	Custom orb 16mm rib with Insulation	Trimdek Hi-Ten 29mm rib with Insulation	Klip-Lok Hi-Ten 41mm rib with Insulation
Fibertex™ Rockwool ANTICON	1.5	T	12-11* x 65mm Type 17	12-11* x 65mm Type 17	*14 x 75mm Type 17
Glasswool ANTICON™	1.5	S	12-14* x 65mm Tek	12-14* x 65mm Tek	12* x 75mm Tek
Fibertex™ Rockwool ANTICON	2.0	T	12-11* x 65mm Type 17	12-11* x 65mm Type 17	*14 x 75mm Type 17
Glasswool ANTICON	2.0	S	12-14* x 65mm Tek	12-14* x 65mm Tek	*12 x 75mm Tek
Glasswool ACOUSTICON™	1.8	T	12-11* x 65mm Type 17	12-11* x 55mm Type 17	10-12 x 45mm Type 17
Glasswool ANTICON	2.5	S	12-14* x 45mm Tek	12-14* x 55mm Tek	10-16 x 16mm Tek
		T	14-11* x 65mm Type 17	14-11* x 55mm Type 17	10-12 x 45mm Type 17
		S	12-14* x 65mm Tek	12-14* x 55mm Tek	10-16 x 22mm Tek

- This table is to be used as a guide only.
- Subject to Engineer's Approval.
- Custom Orb™, Trimdeck™ and Klip-Lok™ are registered trademarks of BHP Building Products.

Metal Roof Deck

Sample Specification

Metal Deck with Cathedral (or Raked) Ceiling and Fully Exposed Rafters

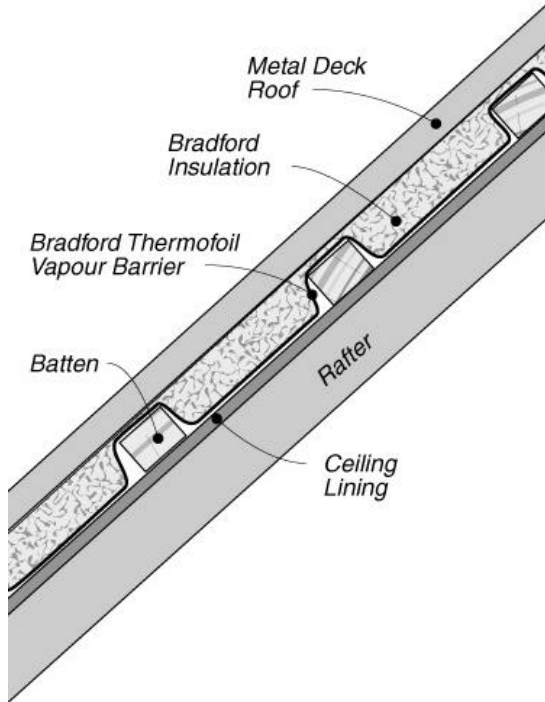

Metal Deck with Cathedral (or Raked) Ceiling and Fully Enclosed Rafters

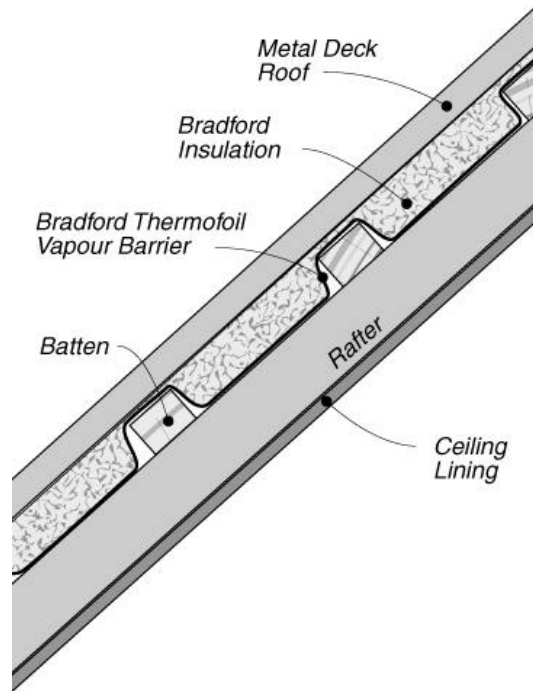

Pitched Metal Deck with Horizontal Ceiling (No Insulation in Ceiling)

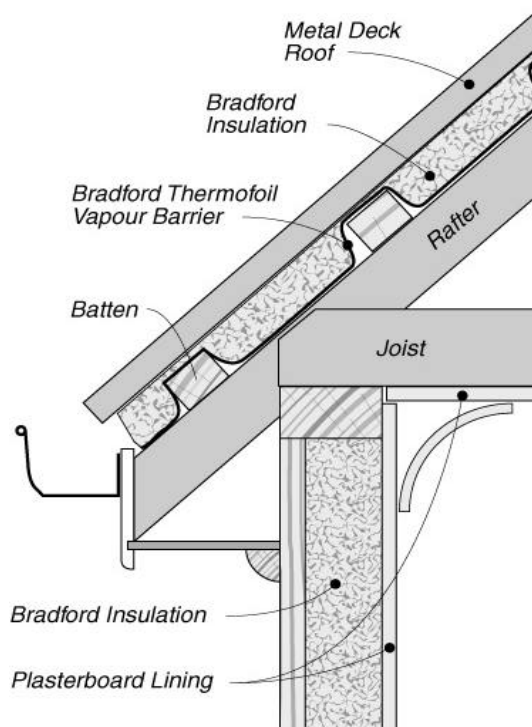

CSR Bradford Insulation, 55 Stennett Rd, Ingleburn, NSW 2565

Ph. (02) 9765 7000 Fax. (02) 9765 7052

Website: www.csr.com.au/bradford